

Dial, Dunlap & Edwards, LLC

COMMERCIAL REAL ESTATE

PUTTING CLIENTS FIRST

OTRANTO PLAZA

Hwy 52 & Rivers Ave
North Charleston, SC

FOR LEASE



Rental Rate \$12.00 psf
Cam, Tax, & Ins. \$1.97
psf + user disposal fee

1,000 sf available

10,000+/- sf available

For more information contact:

Kathy Edwards
Direct: 803-400-9401
kedwards@dderealestate.com

1122 Barnwell Street
Columbia, SC 29201
Phone: (803) 799-6244
Fax: (803) 799-4288

Email: info@dderealestate.com
Website: www.dderealestate.com

Center Information

Square Footage:	91,190
Anchor:	Piggly Wiggly
Year Built:	1987

Demographic Information

2008 Census	1-mile	3-mile	5-mile
Population:	2,877	42,605	113,851
Households:	1,154	17,862	45,408
Average Income:	\$44,014	\$50,872	\$55,540

OTRANTO PLAZA

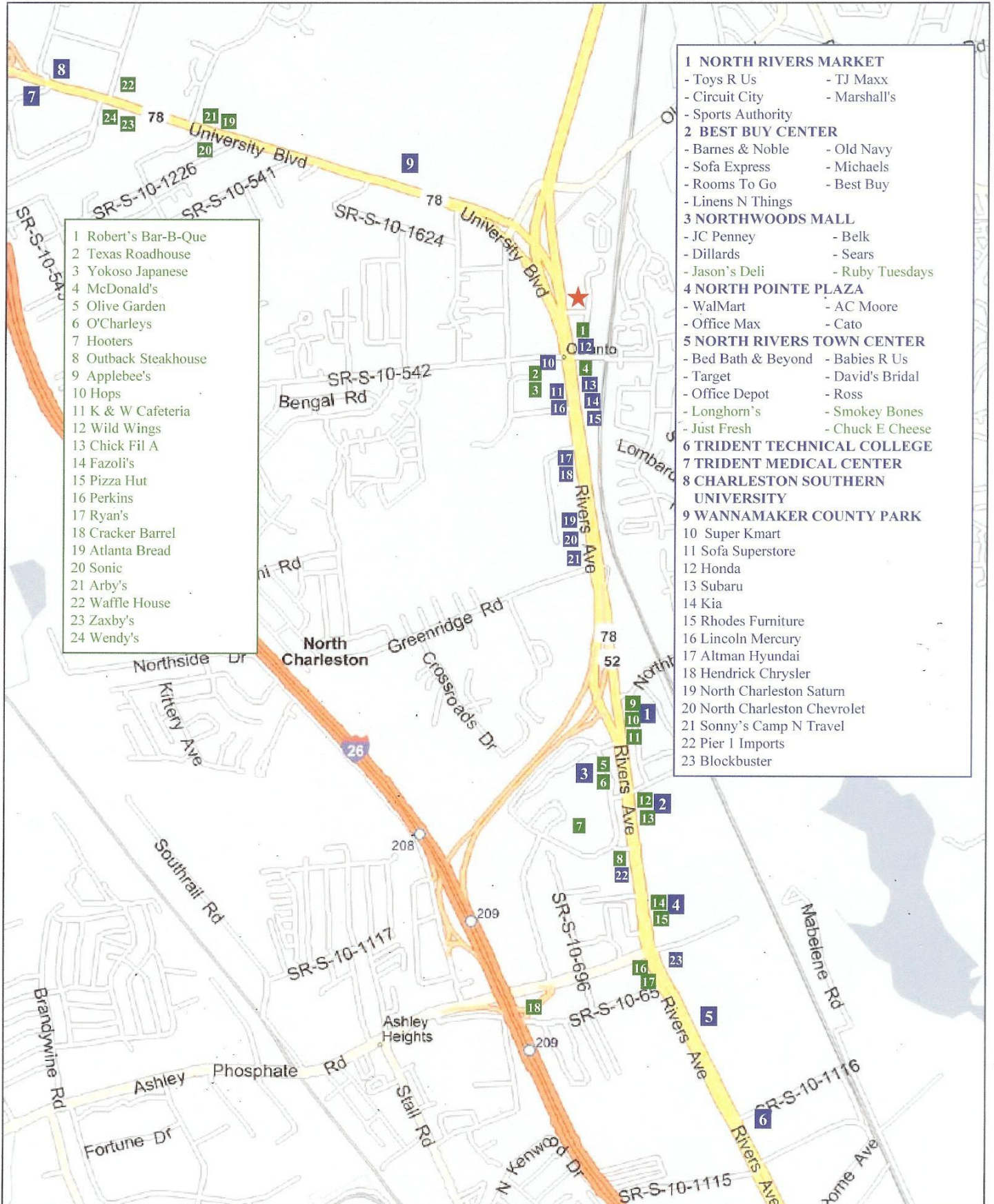

- 1 Robert's Bar-B-Que
- 2 Texas Roadhouse
- 3 Yokoso Japanese
- 4 McDonald's
- 5 Olive Garden
- 6 O'Charleys
- 7 Hooters
- 8 Outback Steakhouse
- 9 Applebee's
- 10 Hops
- 11 K & W Cafeteria
- 12 Wild Wings
- 13 Chick Fil A
- 14 Fazoli's
- 15 Pizza Hut
- 16 Perkins
- 17 Ryan's
- 18 Cracker Barrel
- 19 Atlanta Bread
- 20 Sonic
- 21 Arby's
- 22 Waffle House
- 23 Zaxby's
- 24 Wendy's

- 1 NORTH RIVERS MARKET**
 - Toys R Us
 - Circuit City
 - Sports Authority
 - Barnes & Noble
 - Sofa Express
 - Rooms To Go
 - Linens N Things
 - TJ Maxx
 - Marshall's
 - Old Navy
 - Michaels
 - Best Buy
- 2 BEST BUY CENTER**
 - JC Penney
 - Dillards
 - Jason's Deli
- 3 NORTHWOODS MALL**
 - Belk
 - Sears
 - Ruby Tuesdays
- 4 NORTH POINTE PLAZA**
 - WalMart
 - Office Max
- 5 NORTH RIVERS TOWN CENTER**
 - Bed Bath & Beyond
 - Target
 - Office Depot
 - Longhorn's
 - Just Fresh
- 6 TRIDENT TECHNICAL COLLEGE**
- 7 TRIDENT MEDICAL CENTER**
- 8 CHARLESTON SOUTHERN UNIVERSITY**
- 9 WANNAMAKER COUNTY PARK**
- 10 Super Kmart
- 11 Sofa Superstore
- 12 Honda
- 13 Subaru
- 14 Kia
- 15 Rhodes Furniture
- 16 Lincoln Mercury
- 17 Altman Hyundai
- 18 Hendrick Chrysler
- 19 North Charleston Saturn
- 20 North Charleston Chevrolet
- 21 Sonny's Camp N Travel
- 22 Pier 1 Imports
- 23 Blockbuster

Dial, Dunlap & Edwards, LLC

COMMERCIAL REAL ESTATE

P.O. Box 1504 • COLUMBIA, SC 29202
 1122 BARNWELL STREET • COLUMBIA, SC 29201
 (803) 799-6244 • FAX (803) 799-4288



OTRANTO PLAZA HIGHWAY 52 (RIVERS AVENUE)

BLDG B

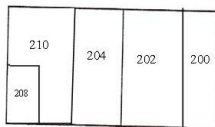

BLDG A

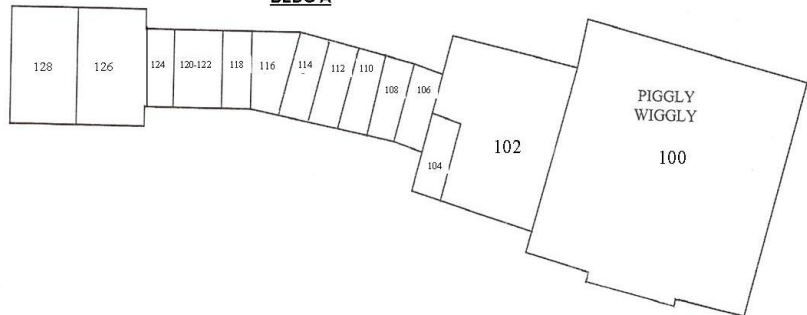

BLDG C

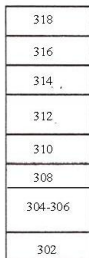

BUILDING A	
100	26,000 SF
102	8,560 SF AVAILABLE
104	1,000 SF
106	1,400 SF
108	1,400 SF
110	1,400 SF
112	1,400 SF
114-116	2,800 SF
118	1,400 SF AVAILABLE
120-122	2,800 SF
124	1,400 SF AVAILABLE
126 -128	10,000 SF

BUILDING B	
200	5,600 SF
202	5,400 SF AVAILABLE
204	4,798 SF AVAILABLE
208	730 SF AVAILABLE
210	4,375 SF

BUILDING C	
302	1,000 SF
302-308	4,000 SF
310	1,000 SF
312	1,000 SF
314	1,000 SF
316	1,000 SF
318	1,000 SF Available