

# Dial, Dunlap & Edwards, LLC

COMMERCIAL REAL ESTATE

*PUTTING CLIENTS FIRST*

Hwy 501 & Legends Blvd  
Myrtle Beach, SC 29579

## FOR LEASE



FOR LEASE:  
2,574 SF available

\$16.00 psf + \$3.69 CAM, Tax  
and Ins.

Horry County

Located on the main  
highway between Conway  
and Myrtle Beach

Adjacent to Tanger Outlets

65,600 average daily traffic  
count

For more information contact:

Michael Edwards  
Direct: 803-400-9402  
[medwards@dderealestate.com](mailto:medwards@dderealestate.com)

1122 Barnwell Street  
Columbia, SC 29201  
Phone: (803) 799-6244  
Fax: (803) 799-4288

Email: [info@dderealestate.com](mailto:info@dderealestate.com)  
Website: [www.dderealestate.com](http://www.dderealestate.com)

Center Information			
Demographic Information			
2010 Census	1-mile	3-mile	5-mile
Population:	4,232	26,718	52,106
Households:	2,061	11,285	21,445
Average Income:	\$50,234	\$52,976	\$54,204

Available

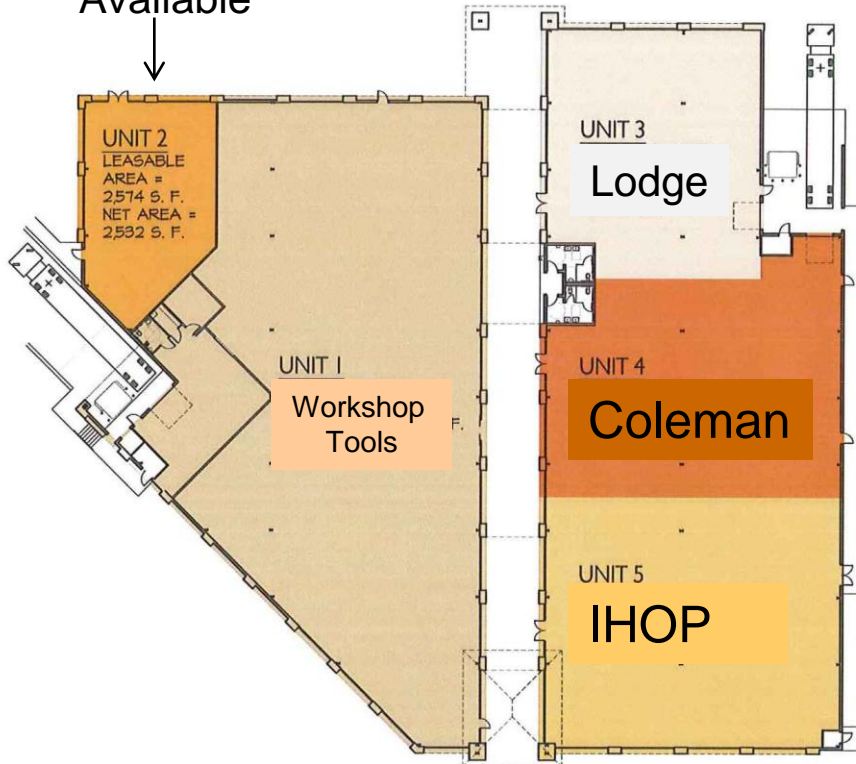

PLAN DATE: 1-4-08

